

SPECIFICATIONS

AO Medium		TeO2
Acoustic Velocity		4.2 mm/μs
Active Aperture*	2 mm 'L' X	0.15 mm 'H'
Center Frequency (Fc)		350 MHz
RF Bandwidth	150 MHz @	-10 dB Return Loss
Input Impedance		50 Ohms Nominal
VSWR @ Fc		1.3 :1 Max
Wavelength		460-685 nm
Insertion Loss		4 % Max
Reflectivity per Surface		1 % Max
Anti-Reflection Coating		MIL-C-48497
Optical Power Density		TDB N/A
Contrast Ratio		1500 :1 Min
Polarization		90 ° To Mounting Plane

PERFORMANCE VS WAVELENGTH

Wavelength (nm)	460	532	632	660	685
Operational RF Power (W)	.63	.90	1.00	1.00	1.00
Bragg Angle (mr)	19.2	22.2	26.3	27.5	28.5
Beam Separation (mr)	38.4	44.4	52.6	55	57

PERFORMANCE VS BEAM DIAMETER

Beam Diameter (μm)	50	50	50	50	50
<i>at Wavelength (nm)</i>	460	532	632	660	685
Diffraction Efficiency (%)	80	80	70	65	60
Rise Time (nsec)	9	9	9	9	9

Outline Drawing:

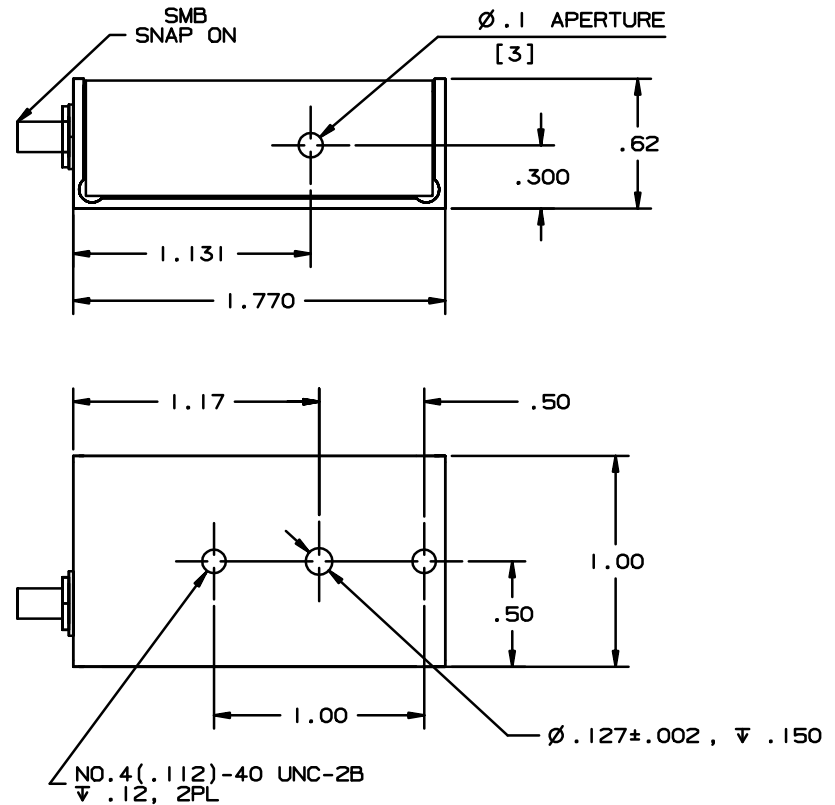

Notes:
 Maximum RF Power is 1.00 Watt.
 Diffraction Efficiency measured at 1.00 Watt RF power and 633nm

THIS DOCUMENT IS THE PROPERTY OF GOOCH AND HOUSEGO. IT IS NOT TO BE REPRODUCED OR DISCLOSED IN WHOLE OR IN PART OTHER THAN BY EMPLOYEES OF GOOCH AND HOUSEGO AND ITS CONTRACTED REPRESENTATIVES AND DISTRIBUTORS. ANY EXCEPTION REQUIRES THE WRITTEN CONSENT OF AN AUTHORIZED REPRESENTATIVE OF GOOCH AND HOUSEGO.

Document
10/31/13
Control

TOLERANCES: .XX ± .01 .XXX ± .005	DR	Geri Scholz 10/9/2013	 AOMO 3350-199 460-685nm
MATERIAL:	CHK		
FINISH:	APP		
	APP		PART NUMBER: 97-03046-01 REV: E SHEET 1 OF 1

*Active Aperture: Aperture over which performance specifications apply.